

# VECTOR SERIES PERISTALTIC PUMPS

## MODEL 2010

### Features

- Dry pump cavity
- Self-priming operation
- Runs dry without damage
- Complete isolation of pumped fluid
- Heavy-duty roller bearings
- Wide range of pump configurations/flows
- No cups, packing or seals
- Low maintenance
- Reversible flow

### Industries Served by Vector Series Pumps

- Waste water and water treatment
- Chemical processing
- Petrochemicals
- Pulp and paper
- Ceramics
- Mining

### Materials of Construction

#### Non-Wetted Parts

Casing and Front Cover: cast iron  
 Rotor Assembly: aluminum  
 Rollers: aluminum

#### Wetted Parts

Hose:  
 STEEL BRAIDED– Nitrile rubber,  
 Natural rubber  
 Inlet/Outlet Connections: Carbon steel  
 ANSI flange

### Dimensions

inches (mm)

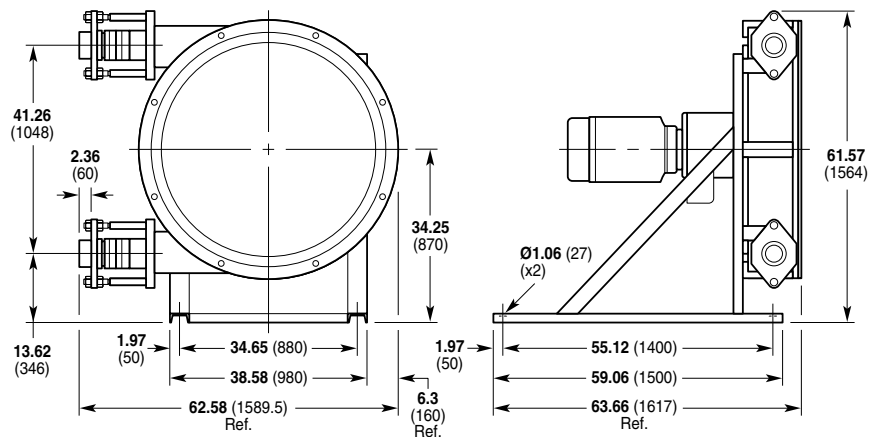

 **Wanner Engineering, Inc.**  
 1204 Chestnut Avenue, Minneapolis, MN 55403 USA  
 (612) 332-5681 FAX (612) 332-6937

Toll Free FAX (USA only) (800) 332-6812  
 Email: sales@wannereng.com Website: www.wannereng.com  
 Document Fax Back System: (510) 745-0440

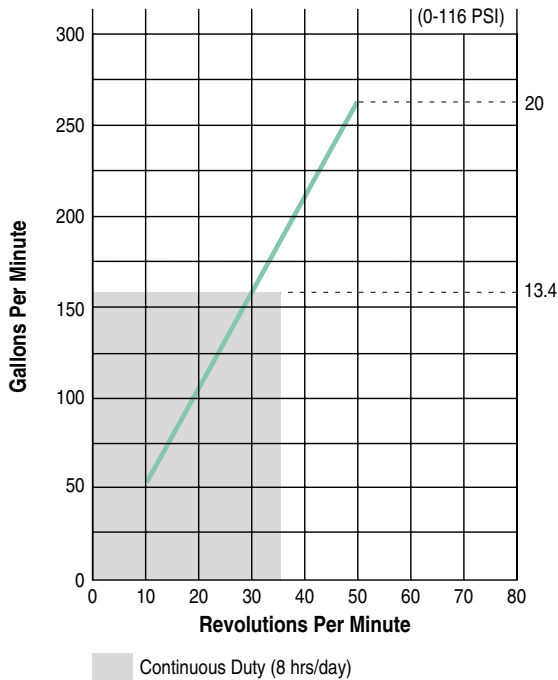

## Fluid Characteristics

<b>Viscosity</b>	100,000 cps (max)
<b>Liquid Temperature</b>	180°F (82° C) (max)
<b>Solid Size</b>	2-1/2 inch (64 mm) (max)
<b>Fiber Length</b>	36 inch (914 mm) (max)

## Specifications

<b>Discharge Pressure</b>	116 psi (8 bar) max
<b>Suction Lift</b>	22 ft (6.7 m)
<b>Suction Pressure (max)</b>	21 psi (1.4 bar)
<b>Horsepower (max)<sup>1</sup></b>	20
<b>Hose Size</b>	100 x 144 x 3250 mm
<b>Displacement</b>	5.28 gal/rev
<b>Weight</b>	2,535 lbs (1,152 kg)

<sup>1</sup> Pumps are shaft driven and require a gearbox and motor. See Ordering Information for details.

## Ordering Information

A complete Vector pump order number uses a 9 character order code to identify the desired hose, fittings and drive. Select the appropriate items from the chart below and use the order code from each group to complete the pump assembly order number.

1	2	0	3	1	4	0	-	5	6	-	7	8	-	9
---	---	---	---	---	---	---	---	---	---	---	---	---	---	---

Order Digit	Order Code	Description
<b>1-4</b>	<b>2010</b>	<b>Pump Designation</b> Model 2010 Shaft Drive Pump
<b>5-6</b>	<b>BS</b> <b>MS</b>	<b>Hose Material/Type</b> Nitrile Rubber, steel-braided Natural Rubber, steel-braided (heavy duty)
<b>7-8</b>	<b>DD</b>	<b>Connector Material/Style</b> Carbon Steel, 6" ANSI flange
<b>9</b>		<b>Drive</b>
	<b>Flow GPM</b>	<b>Gear Ratio</b>
	<b>Pump RPM</b>	<b>Max PSI</b>
	<b>BHP</b>	
<b>*Three Phase, TEFC, 230-460 VAC, 60 Hz</b>		
<b>A</b>	52	174:1
<b>B</b>	79	114:1
<b>C</b>	104	89:1
<b>D</b>	153	59:1
<b>E</b>	211	44:1
<b>X</b>	No Drive	